



Chesapeake Campground

693 South George Washington Hwy.
 Chesapeake, Virginia 23323
chesapeakecampground@gmail.com
ChesapeakeCampgroundVA.com
 (757)485-0149



LEGEND

- 30 AMP W/E
- 50 AMP W/E
- 30 AMP W/E/S
- 50 AMP W/E/S
- Tents
- Cabins
- Water Faucet
- Showers
- Restroom
- Laundry
- Parking
- Camp Host
- Dump Station
- Dumpster

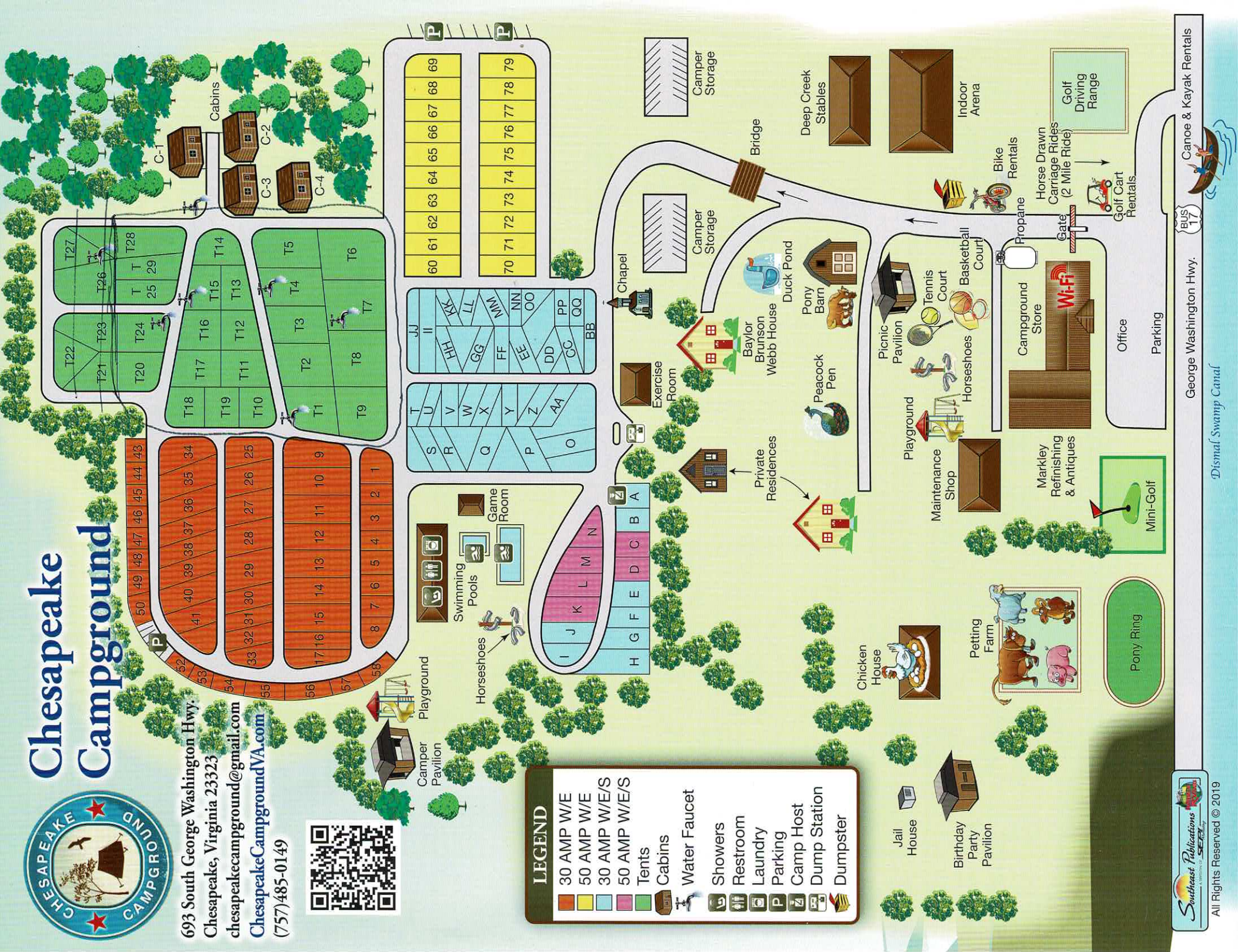

Chesapeake Campground

693 South George Washington Hwy.
Chesapeake, Virginia 23323
(757) 485-0149

OPEN ALL YEAR



RATE CHART

ALL RATES FOR FAMILY OF 2

DAILY RATES (all rent due in advance by 1:00 p.m.):	
Tent Sites.....	\$24.00
30 AMP ELECTRIC-WATER Sites.....	\$36.00
30 AMP ELECTRIC-WATER-SEWER Sites.....	\$41.00
Cabins.....	\$46.00
50 AMP ELECTRIC-WATER Sites.....	\$39.00
50 AMP ELECTRIC-WATER-SEWER Sites.....	\$43.00
Each Additional Member.....	\$.525

Site Type	Season (May-September)	Off Seas. (October-April)
------------------	-------------------------------	----------------------------------

WEEKLY RATES

Tent	\$144	\$144
30amp EW	\$216	\$216
30amp FULL	\$246	\$246
Cabin	\$276	\$276
50amp EW	\$234	\$234
50 AMP FULL	\$258	\$258
Weekly Additional Member Charge		\$26.25

MONTHLY RATES

29 Day	Season (May-September)	Off Seas. (October-April)
30 AMP EW	\$864	\$714
30 AMP FULL	\$984	\$834
50 AMP EW	\$936	\$786
50 AMP FULL	\$1,032	\$882
Monthly Additional Member Charge		\$78.75

GROUP \$7.00 per person - minimum 8 people

CHECK OUT TIME 1:00 P.M. LATE CHECK OUT \$5.00 PER HOUR

VISITORS (Day Rate).....\$5.25per person

DEAD STORAGE.....\$40.00 per month

HONEY WAGON UP TO 2 TANKS.....\$7.00

EACH ADDITIONAL TANK.....\$2.50

GOLF DRIVING RANGE (Approximately 40 balls).....\$4.00

WEEKLY and MONTHLY RATES Apply ONLY When

Rent Is Paid In Advance.

Tax included on all above rates

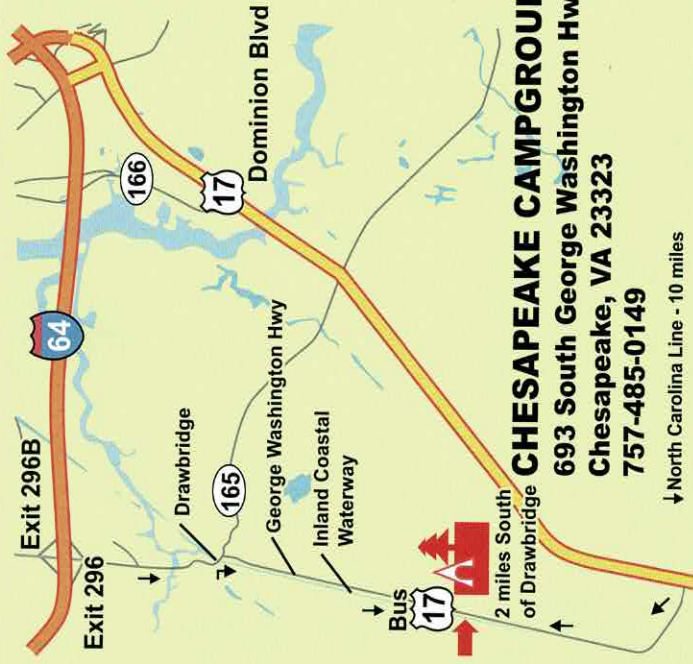

CHESAPEAKE CAMPGROUND
693 South George Washington Hwy
Chesapeake, VA 23323
757-485-0149

↓ North Carolina Line - 10 miles

WEEKLY, MONTHLY & GROUP RATES

available

