

# PIPSICO SCOUT RESERVATION

TOPOGRAPHIC SURVEY OF  
 TIDEWATER COUNCIL #888  
 BOY SCOUTS OF AMERICA  
 RAINY, VA  
 JUNE 24, 2001



PREPARED BY STEREOGRAMMETRIC METHODS  
 HORIZONTAL DATUM NAD83 FROM  
 VIRGINIA STATE PLANE COORDINATE SYSTEM  
 VERTICAL DATUM IS MEAN SEA LEVEL OF 1989  
 FROM PHOTOGRAPHY DATED MARCH 26, 1998

## RED TRAIL

Main entrance to bulk storage	1 to 2	1,157 FT.	27 MI.
Bulk storage to service road	2 to 3	624 FT.	11 MI.
Service road to Kiwanis fork	3 to 4	881 FT.	17 MI.
Kiwanis fork to rifle range	4 to 5	3,142 FT.	60 MI.
Rifle range to PATC spur	5 to 6	4,681 FT.	89 MI.
Spur to river's edge	6 to 7	2,066 FT.	40 MI.
Edge to Kiwanis road	7 to 8	2,132 FT.	40 MI.
Kiwanis to Lions	8 to 9	2,124 FT.	40 MI.
Lions beach to service road	9 to 10	1,165 FT.	30 MI.
Service road to main road	10 to 11	6,485 FT.	120 MI.
Main road to Powhatan gate	11 to 12	1,029 FT.	20 MI.
Powhatan gate to main entrance	12 to 1	2,305 FT.	40 MI.

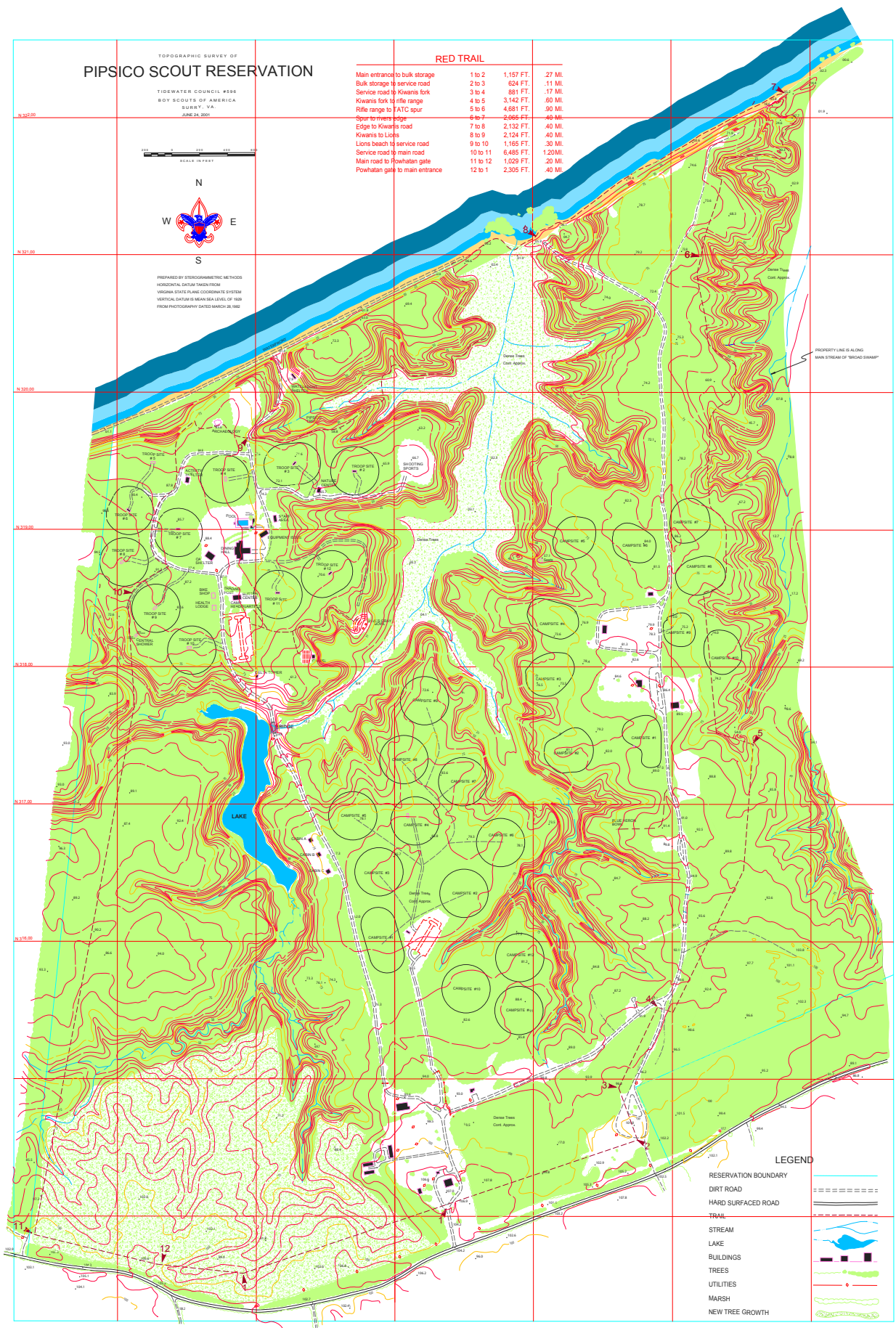

## LEGEND

- RESERVATION BOUNDARY
- DIRT ROAD
- HARD SURFACED ROAD
- TRAIL
- STREAM
- LAKE
- BUILDINGS
- TREES
- UTILITIES
- MARSH
- NEW TREE GROWTH

PROPERTY LINE IS ALONG  
 MAIN STREAM OF "WIGGS BRANCH"