

PIPSICO SCOUT RESERVATION

TOPOGRAPHIC SURVEY OF

TIDEWATER COUNCIL #596
BOY SCOUTS OF AMERICA
SURRY, VA.
MAY 19, 2008

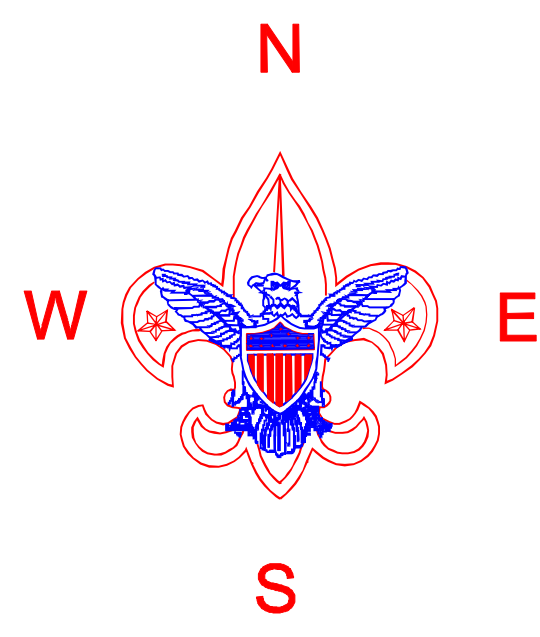
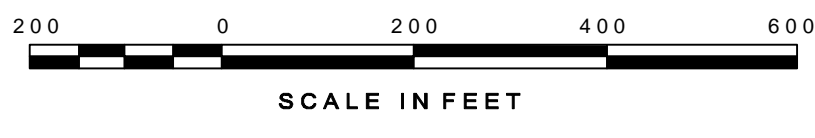

PREPARED BY STEREOGRAMMETRIC METHODS
HORIZONTAL DATUM TAKEN FROM
VIRGINIA STATE PLANE COORDINATE SYSTEM
VERTICAL DATUM IS MEAN SEA LEVEL OF 1929
FROM PHOTOGRAPHY DATED MARCH 28, 1982

RED TRAIL

Main entrance to bulk storage	1 to 2	1,157 FT.	.27 MI.
Bulk storage to service road	2 to 3	624 FT.	.11 MI.
Service road to Kiwanis fork	3 to 4	881 FT.	.17 MI.
Kiwanis fork to rifle range	4 to 5	3,142 FT.	.60 MI.
Rifle range to TATC spur	5 to 6	4,681 FT.	.90 MI.
Spur to rivers edge	6 to 7	2,065 FT.	.40 MI.
Edge to Kiwanis road	7 to 8	2,132 FT.	.40 MI.
Kiwanis to Lions	8 to 9	2,124 FT.	.40 MI.
Lions beach to service road	9 to 10	1,165 FT.	.30 MI.
Service road to main road	10 to 11	6,485 FT.	1.20 MI.
Main road to Powhatan gate	11 to 12	1,029 FT.	.20 MI.
Powhatan gate to main entrance	12 to 1	2,305 FT.	.40 MI.

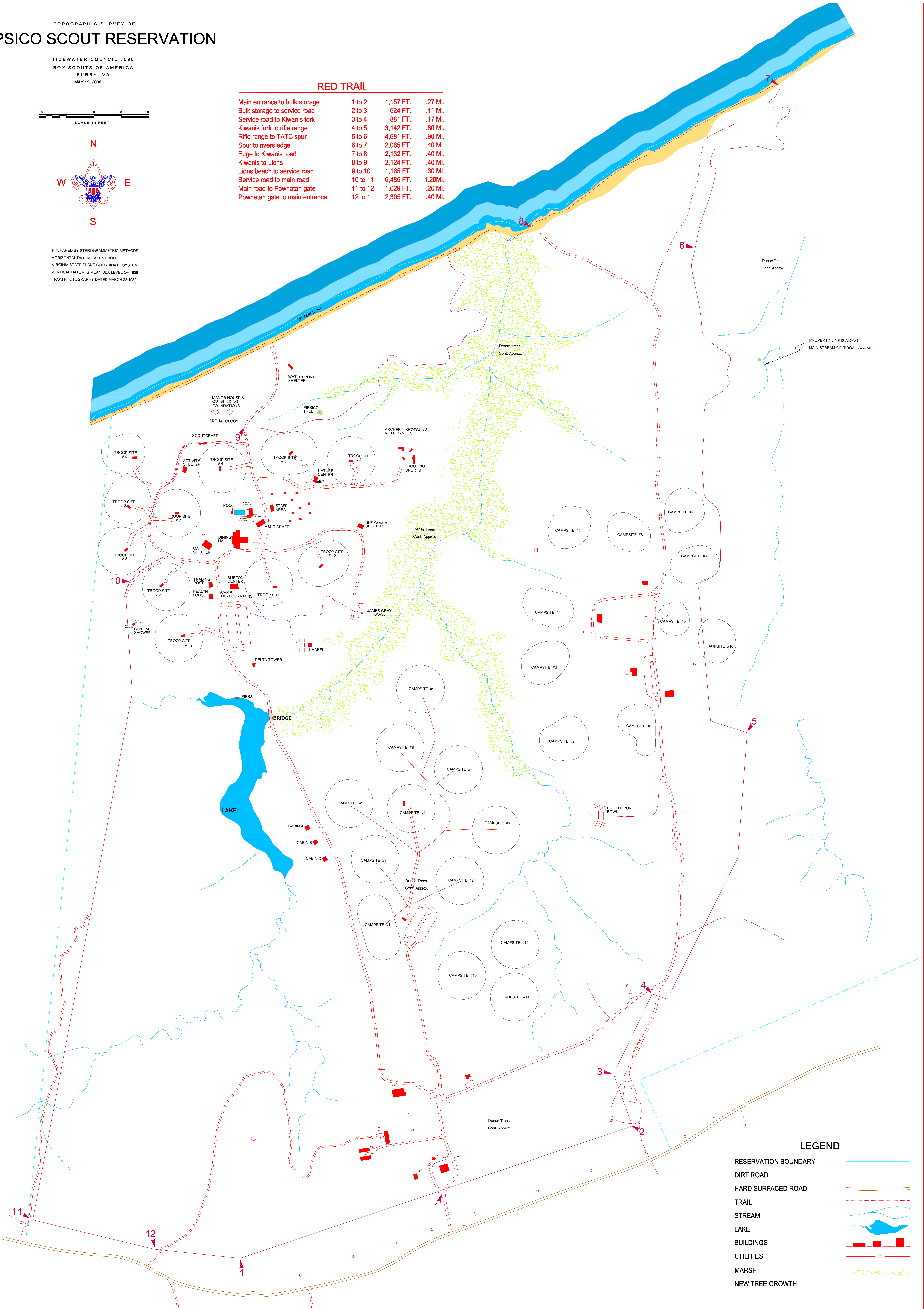

LEGEND

- RESERVATION BOUNDARY
- DIRT ROAD
- HARD SURFACED ROAD
- TRAIL
- STREAM
- LAKE
- BUILDINGS
- UTILITIES
- MARSH
- NEW TREE GROWTH